

4 CONDUCTOR TECK 90 (XLPE) -40°C 1000V

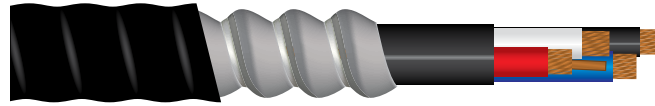

| Product Code | AWG Size | Bonding AWG (bare copper) | Insulation Thickness | | Inner Jacket Thickness | | Appropriate Diameters | | | | Weight Aluminum (Armoured) | | | |
|--------------|----------|---------------------------|----------------------|------|------------------------|------|-----------------------|-------|--------|-------|----------------------------|-------|---------|-------|
| | | | Inches | mm | Inches | mm | Inner Jacket | | Armour | | Outer Covering | | lbs/mft | kg/km |
| 19C1404 | 14 | 14 | .045 | 1.14 | .045 | 1.14 | 0.493 | 12.52 | 0.733 | 18.61 | 0.827 | 21.00 | 282 | 420 |
| 19C1204 | 12 | 14 | .045 | 1.14 | .060 | 1.52 | 0.569 | 14.46 | 0.809 | 20.33 | 0.903 | 22.94 | 356 | 530 |
| 19C1004 | 10 | 12 | .045 | 1.14 | .060 | 1.52 | 0.632 | 16.04 | 0.878 | 22.30 | 0.965 | 24.51 | 436 | 649 |
| 19C0804 | 8 | 10 | .045 | 1.14 | .060 | 1.52 | 0.694 | 17.62 | 0.921 | 23.39 | 1.028 | 26.11 | 583 | 867 |
| 19C0604 | 6 | 8 | .060 | 1.52 | .080 | 2.03 | 0.895 | 22.73 | 1.170 | 29.71 | 1.280 | 32.51 | 838 | 1247 |
| 19C0404 | 4 | 8 | .060 | 1.52 | .080 | 2.03 | 0.995 | 25.27 | 1.270 | 32.26 | 1.351 | 34.31 | 1122 | 1669 |
| 19C0304 | 3 | 6 | .060 | 1.52 | .080 | 2.03 | 1.085 | 27.55 | 1.360 | 34.54 | 1.441 | 36.60 | 1359 | 2022 |
| 19C0204 | 2 | 6 | .060 | 1.52 | .080 | 2.03 | 1.145 | 29.09 | 1.420 | 36.07 | 1.501 | 38.13 | 1580 | 2351 |
| 19C0104 | 1 | 6 | .080 | 2.03 | .080 | 2.03 | 1.303 | 33.11 | 1.578 | 39.50 | 1.663 | 42.24 | 1927 | 2868 |
| 19C04 | 1/0 | 6 | .080 | 2.03 | .080 | 2.03 | 1.394 | 35.40 | 1.669 | 42.39 | 1.774 | 45.06 | 2295 | 3415 |
| 19C004 | 2/0 | 6 | .080 | 2.03 | .080 | 2.03 | 1.488 | 37.81 | 1.757 | 44.63 | 1.865 | 47.37 | 2711 | 4034 |
| 19C0004 | 3/0 | 4 | .080 | 2.03 | .080 | 2.03 | 1.607 | 40.81 | 1.852 | 47.04 | 1.960 | 49.78 | 3395 | 5053 |
| 19C00004 | 4/0 | 4 | .080 | 2.03 | .110 | 2.79 | 1.793 | 45.55 | 2.033 | 51.64 | 2.141 | 54.38 | 4197 | 6239 |
| 19C2504 | 250 | 4 | .090 | 2.29 | .110 | 2.79 | 1.952 | 49.57 | 2.302 | 58.52 | 2.417 | 59.59 | 4828 | 7230 |
| 19C3004 | 300 | 4 | .090 | 2.29 | .110 | 2.79 | 2.077 | 52.76 | 2.427 | 61.65 | 2.542 | 65.57 | 5630 | 8378 |
| 19C3504 | 350 | 3 | .090 | 2.29 | .110 | 2.79 | 2.189 | 55.60 | 2.539 | 64.49 | 2.654 | 67.41 | 6399 | 9522 |
| 19C4004 | 400 | 3 | .090 | 2.29 | .110 | 2.79 | 2.294 | 58.26 | 2.644 | 67.16 | 2.833 | 71.96 | 7132 | 10613 |
| 19C5004 | 500 | 3 | .090 | 2.29 | .110 | 2.79 | 2.481 | 63.02 | 2.831 | 71.91 | 3.020 | 76.71 | 8555 | 12732 |
| 19C7504 | 750 | 2 | .090 | 2.29 | .140 | 3.56 | 3.09 | 78.49 | 3.34 | 84.84 | 3.50 | 88.90 | 12291 | 18330 |