

CATEGORY 6 ALUMINUM ARMoured

Insulation Colours	Pair 1: ColorTip Light Blue, Blue	Pair 2: ColorTip Light Orange, Orange
	Pair 3: ColorTip Light Green, Green	Pair 4: ColorTip Light Brown, Brown
Jacket	Inner and outer PVC jacket	
Armour	Aluminum Interlocked Armour	
Temperature	-40°C to 75°C	
Approvals	CEC C(UL) Type CM TIA/EIA 568.B.2 CAT 6	
Applications	Industrial ethernet cable, harsh environments, 350MHz enhanced Category 6, Gigabit Ethernet, 100 Base TX, 100 Base VG ANYLAN Sunlight and oil resistant	

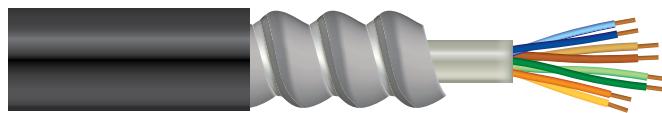

Product Code	AWG	Pairs	Strand & Cond.	Insul. Mat'l. & Dia. (in.)	Nom. OD (in)	Nom. Vel. of Prop.	Nom. Cap. (pF/ft)	Rating	Cable Weight (lbs/mft)	Jacket Colours
36121872A	23	4	Bonded Pairs Solid BC	PO 0.038	0.688	70%	15.0	CSA/FT4 UL 1666	154	Black or Blue

DUAL CATEGORY 6 ALUMINUM ARMoured

Insulation Colours	Pair 1: ColorTip White-Blue, Blue	Pair 2: ColorTip White-Orange, Orange
	Pair 3: ColorTip White-Green, Green	Pair 4: ColorTip White-Brown, Brown
Jacket	Inner and outer PVC jacket	
Armour	Aluminum Interlocked Armour	
Temperature	-20°C to 75°C	
Approvals	CEC C(UL) Type CM TIA/EIA 568.B.2 CAT 6	
Applications	100 Base TX, 100 Base VG ANYLAN, and 155 ATM, use in high bandwidth existing or future applications such as 622 ATM and gigabit Ethernet	

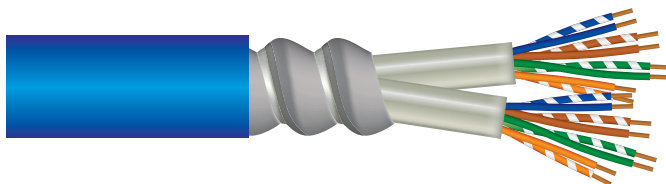

Product Code	AWG	Pairs	Strand & Cond.	Insul. Mat'l. & Dia. (in.)	Nom. OD (in)	Nom. Imp. (ohms)	Rating	Cable Weight (lbs/mft)	Jacket Colours
37ZA2408	23	4 (x 2)	Solid BC	PVC 0.037	0.766	100±15	CSA/FT4 UL 1666	179	Blue