

CATEGORY 6E ALUMINUM ARMoured

Insulation Colours
Pair 1: ColorTip Light Blue, Blue
Pair 2: ColorTip Light Orange, Orange
Pair 3: ColorTip Light Green, Green
Pair 4: ColorTip Light Brown, Brown

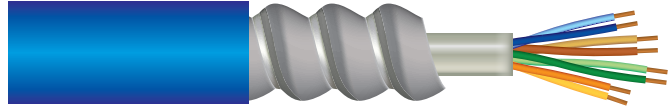

Jacket Inner and outer PVC

Armour Aluminum Interlocked Armour

Temperature -20°C to 60°C

Approvals
UL 444
CSA C22.2 No. 214-08
ANSI/TIA-568 C.2
RoHS-compliant

Applications Gigabit Ethernet and other bandwidth intensive applications.
10BASE-T through 1000BASE-T Ethernet, ATM and token ring, supports legacy protocols and applications.

Product Code	AWG	Pairs	Cond	Insul. Mat'l.	Nom. OD (in)	Nom. Vel. Of Prop.	Nom. Imp. (ohms)	Rating	Cable Weight (lbs/mft)	Jacket Colour
37ZA2404EL	23	4	Solid BC	PO	0.55	70%	100 ± 15	CSA CMR UL 444	104	Blue