

10 AWG Multi-Conductor Teck 90 (XLPE) 600V

- Conductor** 10 AWG. round concentric lay class "B" stranded copper
- Armour** Aluminum interlocked armour
- Insulation** Cross-linked Polyethylene (XLPE) Type RW90
- Temperature** -40°C to +90°C
- Voltage** 600V
- Inner Jacket** Polyvinyl Chloride (PVC), black
- Outer Jacket** Low acid gas, flame-retardant, moisture and sunlight resistant Polyvinyl Chloride (PVC), black
- Applications** Can be directly buried, installed in raceways, including cable tray in wet or dry environments. Cable is suitable for use in outdoor exposed applications and is rated for damp or dry locations in -40°C (-40°F) environments.
- Approvals** CSA Standard C22.2 No. 131, No.38 and No.2256
RoHS Flame test compliances: CSA FT4 Hazardous Location
SUN RES (outer jacket) SUN RES on inner jacket and insulated conductor available upon request
Direct Burial Acid Gas: CSA AG14
- Colour Coding** 2 Conductor: black, white
3 Conductor: black, red, blue
4 Conductor: black, red, blue, white
5 - 50 Conductor: black with printed number code

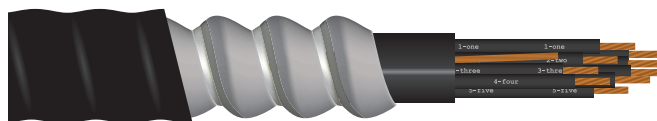

Product Code	No. of Cond.	Bonding AWG (Bare Copper)	Insulation Thickness		Inner Jacket Thickness		Inner Jacket Diameter		Armour Diameter		Outer Jacket Diameter		Weight Aluminum (Armoured)	
			Inches	mm	Inches	mm	Inches	mm	Inches	mm	Inches	mm	lbs/mft	kg/km
19A1002	2	10	0.030	0.76	0.045	1.14	0.452	11.48	0.684	17.37	0.769	19.53	272	405
19A1003	3	10	0.030	0.76	0.045	1.14	0.481	12.23	0.712	18.08	0.798	20.27	339	504
19A1004	4	10	0.030	0.76	0.045	1.14	0.560	14.22	0.783	19.89	0.867	22.02	383	570
19A1006	6	10	0.030	0.76	0.060	1.52	0.671	17.04	0.900	22.86	0.985	25.01	517	770
19A1008	8	10	0.030	0.76	0.060	1.52	0.726	18.44	0.954	24.23	1.047	26.59	617	918
19A1010	10	10	0.030	0.76	0.060	1.52	0.840	21.33	1.100	27.94	1.188	30.18	776	1154
19A1012	12	10	0.030	0.76	0.080	2.03	0.917	23.29	1.178	29.92	1.266	32.16	885	1318
19A1015	15	10	0.030	0.76	0.080	2.03	0.987	25.06	1.247	31.67	1.335	33.91	1056	1571
19A1020	20	10	0.030	0.76	0.080	2.03	1.098	27.89	1.357	34.47	1.445	36.70	1291	1966
19A1025	25	10	0.030	0.76	0.080	2.03	1.229	31.22	1.504	38.20	1.596	40.54	1528	2274
19A1030	30	10	0.030	0.76	0.080	2.03	1.317	33.45	1.573	39.95	1.680	42.67	1770	2634
19A1040	40	10	0.030	0.76	0.080	2.03	1.567	39.80	1.917	48.69	1.967	49.96	2298	3421

10AWG_MC_T90_600V.pdf