

1 Conductor Teck 90 (XLPE) 5KV Unshielded

- Conductor** Bare copper compact Class B strand
- Armour** Aluminum interlocked armour
- Insulation** Cross-linked Polyethylene (XLPE) Type RW90
- Temperature** -40°C to +90°C wet
- Voltage** 5000V
- Inner Jacket** Polyvinyl Chloride (PVC), black
- Outer Jacket** Polyvinyl Chloride (PVC), Orange
- Shield** Thermoset semi-conducting shield is extruded over the conductor
- Ground** Concentric serving of solid bare copper wires applied over the insulation
- Applications** Cable can be directly buried, installed in raceways, including cable tray in wet or dry environments. Cable is suitable for use in outdoor exposed applications and is rated for damp or dry locations in -40°C (-40°F) environments.
- Approvals** Industry compliances: CSA Standard C22.2 No. 131 and No. 174
 Flame test compliances: CSA FT1 and FT4, IEE 383 & 1202 (70,000 BTU/hr), UL 1581 (70,000 BTU/hr), ICEA T-30-520 (70,000 BTU/hr)
 Other compliances: Hazardous location rating HL, EPA 40 CFR, Part 261 for leachable lead content per TCLP method, OSHA Acceptable, RoHS Compliant
- Colour Coding** Black conductor

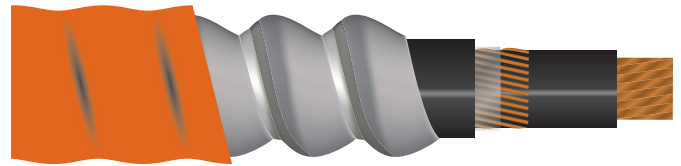

Product Code	AWG Size	Bonding AWG (Bare Copper)	Insulation Thickness		Inner Jacket Thickness		Inner Jacket Diameter		Armour Diameter		Outer Jacket Diameter		Weight Aluminum (Armoured)	
			Inches	mm	Inches	mm	Inches	mm	Inches	mm	Inches	mm	lbs/mft	kg/km
20A00001	4/0	3	0.090	2.29	0.060	1.52	0.935	23.75	1.210	30.73	1.314	33.38	1413	2103
20A2501	250	2	0.090	2.29	0.060	1.52	1.019	25.88	1.294	32.87	1.405	35.69	1607	2391
20A3001	300	2	0.090	2.29	0.060	1.52	1.069	27.15	1.344	34.14	1.457	37.00	1792	2666
20A3501	350	1	0.090	2.29	0.060	1.52	1.115	28.32	1.390	35.31	1.500	38.10	1971	2933
20A4001	400	1	0.090	2.29	0.060	1.52	1.169	29.69	1.444	36.68	1.573	39.95	2155	3207
20A5001	500	1/0	0.090	2.29	0.060	1.52	1.269	32.23	1.544	39.22	1.669	42.39	2692	4006
20A6001	600	1/0	0.090	2.29	0.060	1.52	1.348	34.25	1.623	41.22	1.752	44.50	2993	4454
20A7501	750	2/0	0.090	2.29	0.060	1.52	1.454	36.93	1.729	43.92	1.854	47.09	3722	5539
20A10001	1000	2/0	0.090	2.29	0.060	1.52	1.631	41.41	1.981	50.32	2.115	53.72	4652	6923

Single conductor comes with concentric binding conductor, and is only available with an aluminum armour, steel armour is not permitted.