

# 3 Conductor Teck 90 (XLPE) 5KV Unshielded

- Conductor** Bare copper compact Class B strand
- Armour** Aluminum interlocked armour
- Insulation** Cross-linked Polyethylene (XLPE)
- Temperature** -40°C to +90°C wet
- Voltage** 5000V
- Inner Jacket** Polyvinyl Chloride (PVC), black
- Outer Jacket** Polyvinyl Chloride (PVC), Orange
- Ground** One uninsulated stranded bare copper conductor
- Applications** Cable can be directly buried, installed in raceways, including cable tray in wet or dry environments. Cable is suitable for use in outdoor exposed applications and is rated for damp or dry locations in -40°C (-40°F) environments.

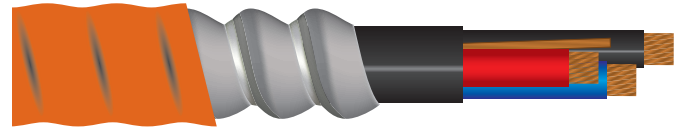

- Approvals** Industry compliances: CSA Standard C22.2 No. 131 and No. 174  
 Flame test compliances: CSA FT1 and FT4, IEE 383 & 1202 (70,000 BTU/hr), UL 1581 (70,000 BTU/hr), ICEA T-30-520 (70,000 BTU/hr)  
 Other compliances: Hazardous location rating HL, EPA 40 CFR, Part 261 for leachable lead content per TCLP method, OSHA Acceptable, RoHS Compliant

Product Code	AWG Size	Bonding AWG (Bare Copper)	Insulation Thickness		Inner Jacket Thickness		Inner Jacket Diameter		Armour Diameter		Outer Jacket Diameter		Weight Aluminum (Armoured)	
			Inches	mm	Inches	mm	Inches	mm	Inches	mm	Inches	mm	lbs/mft	kg/km
20A0603	6	8	0.090	2.29	0.080	2.03	1.051	26.69	1.326	33.68	1.435	36.45	872	1298
20A0403	4	8	0.090	2.29	0.080	2.03	1.146	29.11	1.421	36.09	1.530	38.86	1155	1720
20A0303	3	6	0.090	2.29	0.080	2.03	1.200	30.49	1.475	37.46	1.584	40.23	1322	1968
20A0203	2	6	0.090	2.29	0.080	2.03	1.266	32.15	1.541	39.14	1.670	42.42	1503	2237
20A0103	1	6	0.090	2.29	0.080	2.03	1.335	33.91	1.610	40.89	1.739	44.17	1732	2578
20A03	1/0	6	0.090	2.29	0.080	2.03	1.415	35.95	1.690	42.93	1.819	46.20	2013	2997
20A003	2/0	6	0.090	2.29	0.080	2.03	1.500	38.10	1.775	45.09	1.904	48.36	2339	3481
20A0003	3/0	4	0.090	2.29	0.080	2.03	1.606	40.80	1.956	49.68	2.090	53.09	2929	4359
20A00003	4/0	4	0.090	2.29	0.080	2.03	1.724	43.79	2.074	52.68	2.208	56.08	3544	5274
20A2503	250	4	0.090	2.29	0.110	2.79	1.882	47.80	2.232	56.69	2.366	60.10	4032	6001
20A3503	350	3	0.090	2.29	0.110	2.79	2.094	53.19	2.444	62.08	2.578	65.48	5242	7800
20A5003	500	3	0.090	2.29	0.110	2.79	2.355	59.81	2.705	68.71	2.839	72.11	7053	10495
20A7503	750	2	0.090	2.29	0.110	2.79	2.914	74.01	3.164	80.36	3.318	84.28	9712	14453